

# ON/OFF GRID SOLAR INVERTER

# VENUS-10200



### Features

- Pure sine wave solar inverter(on/off Grid)
- Output power factor 1.0
- WIFI&GPRS available for IOS and Android
- Inverter can run without battery
- One-key restoration to factory Settings
- Built-in Lithium battery automatic activation
- Built-in 160A MPPT solar charger (for 8.2kw,10.2kw)
- High PV input voltage range(90~500VDC)
- Built-in anti-dust kit for harsh environment
- Smart battery charge design to optimize battery life
- Dual output
- Dual PV input
- Touch button
- On Off Grid Work Mode

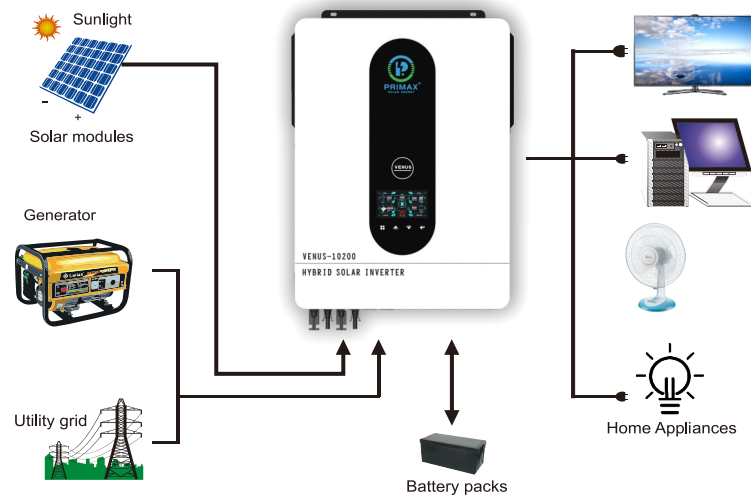

| MODEL                          | VENUS-7200   | VENUS-8200        | VENUS-10200        |
|--------------------------------|--------------|-------------------|--------------------|
| Phase                          | 1-phase      |                   |                    |
| Maximum PV Input Power         | 8200W        | 8200W 5600W+5600W | 10200W 6100W+6100W |
| Rated Output Power             | 7200W/7200VA | 8200W/8200VA      | 10200W/10200VA     |
| Maximum Solar Charging Current | 140A         | 160A              | 160A               |

### GRID-TIE OPERATION

#### PV INPUT (DC)

|  |              |       |       |             |
|--|--------------|-------|-------|-------------|
| Nominal DC Voltage/Maximum DC Voltage      | 360/500VDC   |       |       |             |
| Start-up Voltage / Initial Feeding Voltage | 90VDC/120VDC |       |       |             |
| MPPT Voltage Range                         | 90~450VDC    |       |       |             |
| Maximum Input Current                      | 1/23A        | 1/23A | 2/18A | 1/23A 2/18A |

### GRID OUTPUT (AC)

|                        |                |       |       |
|------------------------|----------------|-------|-------|
| Nominal Output Voltage | 220/230/240VAC |       |       |
| Output Voltage Range   | 190~253VDC     |       |       |
| Nominal Output Current | 31.3A          | 35.6A | 44.3A |
| Power Factor           | >0.99          |       |       |

### EFFICIENCY

|                                       |     |  |  |
|---------------------------------------|-----|--|--|
| Maximum Conversion Efficiency (DC/AC) | 98% |  |  |
|---------------------------------------|-----|--|--|

### TWO LOAD OUTPUT POWER

|                                  |       |       |        |
|----------------------------------|-------|-------|--------|
| Full Load                        | 7200W | 8200W | 10200W |
| Maxium Main Load                 | 7200W | 8200W | 10200W |
| Maxium Second Load(battery mode) | 2400W | 2733W | 3400W  |
| Maxium Load Cut Off Voltage      | 52VDC | 52VDC | 52VDC  |
| Maxium Load Return Voltage       | 54VDC | 54VDC | 54VDC  |

### OFF-GRID OPERATION

#### AC INPUT

|  |                       |     |     |
|--|-----------------------|-----|-----|
| AC Start-up Voltage / Auto Restart Voltage | 120-140VAC/180VAC     |     |     |
| Acceptable Input Voltage Range             | 90-280VACor170-280VAC |     |     |
| Frequency Range                            | 49~51±1HZ             |     |     |
| Maximum AC Input Current                   | 40A                   | 40A | 50A |

#### PV INPUT (DC)

|                                       |            |       |       |             |
|---------------------------------------|------------|-------|-------|-------------|
| Nominal DC Voltage/Maximum DC Voltage | 360/500VDC |       |       |             |
| MPPT Voltage Range                    | 90~450VDC  |       |       |             |
| Maximum Input Current                 | 1/23A      | 1/23A | 2/18A | 1/23A 2/18A |

### BATTERY MODE OUTPUT (AC)

|                        |                |  |  |
|------------------------|----------------|--|--|
| Nominal Output Voltage | 220/230/240VAC |  |  |
| Output Waveform        | Pure sine wave |  |  |
| Efficiency (DC to AC)  | 94%            |  |  |

### BATTERY & CHARGER

|                                |       |      |      |
|--------------------------------|-------|------|------|
| Nominal DC Voltage             | 48VDC |      |      |
| Maximum Solar Charging Current | 140A  | 160A | 160A |
| Maximum AC Charging Current    | 120A  | 140A | 140A |
| Maximum Charging Current       | 140A  | 160A | 160A |

### HYBRID OPERATION

#### PV INPUT (DC)

|  |              |       |       |             |
|--|--------------|-------|-------|-------------|
| Nominal DC Voltage/Maximum DC Voltage      | 360/500VDC   |       |       |             |
| Start-up Voltage / Initial Feeding Voltage | 90VDC/120VDC |       |       |             |
| MPPT Voltage Range                         | 90~450VDC    |       |       |             |
| Maximum Input Current                      | 1/23A        | 1/23A | 2/18A | 1/23A 2/18A |

### GRID OUTPUT (AC)

|                        |                |       |       |
|------------------------|----------------|-------|-------|
| Nominal Output Voltage | 220/230/240VAC |       |       |
| Output Voltage Range   | 190~253VDC     |       |       |
| Nominal Output Current | 31.3A          | 35.6A | 44.3A |

#### AC INPUT

|  |                       |      |      |
|--|-----------------------|------|------|
| AC Start-up Voltage / Auto Restart Voltage | 120-140VAC/180VAC     |      |      |
| Acceptable Input Voltage Range             | 90-280VACor170-180VAC |      |      |
| Maximum AC Input Current                   | 40A                   | 40A  | 50A  |
| Maximum AC Charging Current                | 120A                  | 140A | 140A |

### GENERAL

#### PHYSICAL

|                               |             |             |             |             |             |
|-------------------------------|-------------|-------------|-------------|-------------|-------------|
| Dimension, D x W x H (mm)     | 500*390*130 | 500*390*130 | 530*420*160 | 500*390*130 | 530*420*160 |
| Carton Dimension,D X W XH(mm) | 588*463*205 |             | 618*463*205 | 588*463*205 | 618*463*205 |
| Net Weight (kgs)              | 13.6        | 14.5        | 14.6        | 14.8        | 15          |
| Gross Weight(kgs)             | 14.9        | 16          | 16.1        | 16.2        | 16.5        |

#### INTERACE

|                    |                                       |
|--------------------|---------------------------------------|
| Communication Port | RS232/RS485/WIFI/GPRS/LITHIUM BATTERY |
|--------------------|---------------------------------------|

#### ENVIRONMENT

|                       |   |
|-----------------------|---|
| Humidity              | 5% to 95% Relative Humidity(Non ~ condensing) |
| Operating Temperature | -10°C ~ 50°C                                  |

#### STANDARD

|                   |    |
|-------------------|----|
| Compliance Safety | CE |
|-------------------|----|