

ON/OFF GRID SOLAR INVERTER

VENUS-4200



120A
MAX PV
CHARGING

PURE
SINE WAVE

WORKS
WITH AND WITHOUT
BATTERY

UPGRADED
MPPT

LI-ION

BUILT IN
ANTI DUST
KIT

APP

WIFI&GPRS

LCD Display

RGB
LIGHTS



- Features
- Pure sine wave solar inverter(on/off Grid)
 - Output power factor 1.0
 - WIFI&GPRS available for IOS and Android
 - Inverter can run without battery
 - One-key restoration to factory Settings
 - Built-in Lithium battery automatic activation
 - Built-in 120A MPPT Solar charge:max 6200W(for 3.6KW/4.2KW), max 6500W (for 6.2KW)
 - High PV input voltage range(60~500VDC)
 - Built-in anti-dust kit for harsh environment
 - Smart battery charge design to optimize battery life
 - Dual output

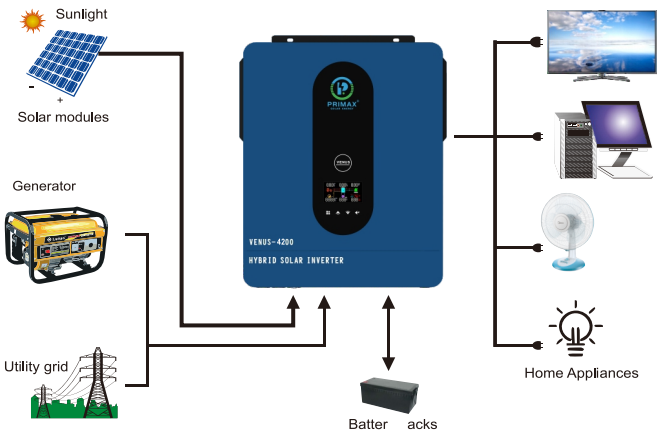

MODEL	VENUS-3600	VENUS-4200	VENUS-6200
Phase	1-phase		
PV INPUT	6200W	6200W	7200W
Rated Output Power	3600W	4200W	6200W
Maximum Solar Charging Current	120A		
GRID-TIE OPERATION			
PV INPUT (DC)			
Nominal DC Voltage/Maximum DC Voltage	360/500VDC		
Start-up Voltage / Initial Feeding Voltage	60VDC/90VDC		
MPPT Voltage Range	60~450VDC		
Maximum Input Current	1/18A		1/22A

GRID OUTPUT (AC)			
Nominal Output Voltage		220/230/240VAC	
Output Voltage Range		195.5~253VAC	
Nominal Output Current		15.7A	18.2A 27.0A
Power Factor		>0.99	
EFFICIENCY			
Maximum Conversion Efficiency (DC/AC)		98%	
TWO LOAD OUTPUT POWER			
Full Load		3600W	4200W 6200W
Maxium Main Load		3600W	4200W 6200W
Maxium Second Load(battery mode)		1200W	1400W 2067W
Maxium Load Cut Off Voltage		26VDC	26VDC 52VDC
Maxium Load Return Voltage		27VDC	27VDC 54VDC
OFF-GRID OPERATION			
AC INPUT			
AC Start-up Voltage / Auto Restart Voltage		120-140VAC/180VAC	
Acceptable Input Voltage Range		90-280VAC or 170-280VAC	
Frequency Range		49~51±1HZ	
Maximum AC Input Current		30A	30A 40A
PV INPUT (DC)			
Nominal DC Voltage/Maximum DC Voltage		360/500VDC	
MPPT Voltage Range		60~450VDC	
Maximum Input Current		1/18A	1/22A
BATTERY MODE OUTPUT (AC)			
Nominal Output Voltage		220/230/240VAC	
Output Waveform		Pure sine wave	
Efficiency (DC to AC)		94%	
BATTERY & CHARGER			
Nominal DC Voltage		24VDC	48VDC
Maximum Solar Charging Current		120A	140A 120A
Maximum AC Charging Current		100A	100A 100A
Maximum Charging Current		120A	140A 120A
HYBRID OPERATION			
PV INPUT (DC)			
Nominal DC Voltage/Maximum DC Voltage		360/500VDC	
Start-up Voltage / Initial Feeding Voltage		90VDC/120VDC	
MPPT Voltage Range		60~450VDC	
Maximum Input Current		1/18A	1/22A
GRID OUTPUT (AC)			
Nominal Output Voltage		220/230/240VAC	
Output Voltage Range		195.5~253VAC	
Nominal Output Current		15.7A	18.2A 27.0A
AC INPUT			
AC Start-up Voltage / Auto Restart Voltage		120-140VAC/180VAC	
Acceptable Input Voltage Range		90-280VAC or 170-280VAC	
Maximum AC Input Current		30A	30A 40A
Maximum AC Charging Current		100A	
GENERAL			
PHYSICAL			
Dimension, D x W x H (mm)		420*350*110	
Carton Dimension,D X W XH(mm)		500*415*180	
Net Weight (kgs)		8	8.5 9
Gross Weight(kgs)		9	9.5 10
INTERACE			
Communication Port		RS232/RS485/WIFI/GPRS/LITHIUM BATTERY	
ENVIRONMENT			
Humidity		5% to 95% Relative Humidity(Non ~ condensing)	
Operating Temperature		-10°C ~ 50°C	
STANDARD			
Compliance Safety		CE	