

SOLAR CAPACITY **5500W**



**PRIMAX**<sup>®</sup>  
SOLAR ENERGY



# GALAXY DUAL PV5500+ PRO

## MPPT Solar Inverter

### FEATURES :

- Dual output for smart load management
- Maximum PV input current 27A
- Wide PV input voltage range 60VDC~450VDC
- Touchable button with large 4.3" colored LCD
- Customizable status LED ring with RGB lights
- Built-in Wifi for mobile monitoring (Android/iOS App available)
- Supports USB On-the-Go function
- Reserved communication port (RS485, CAN-BUS or RS232) for BMS
- Maximum charging current 120A
- Battery independent design
- Feed-in to the grid with storage backup
- Battery equalization extends lifecycle
- Built-in anti-dust kit
- Data log event stored in the inverter



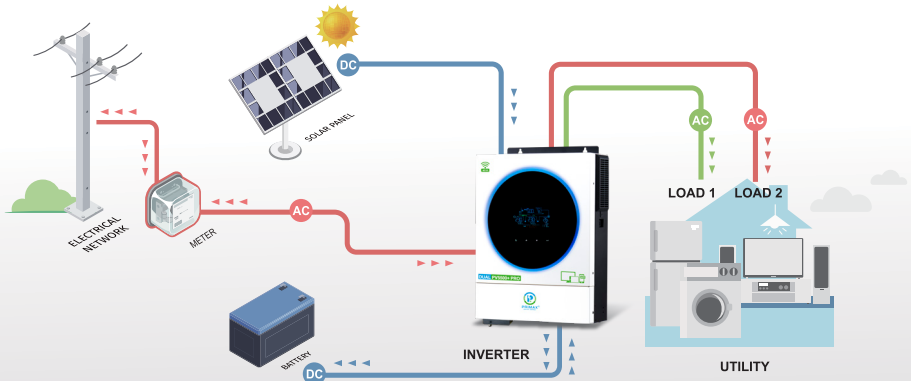

Dual Output Operation

When PV energy and Utility are available and sufficient

1

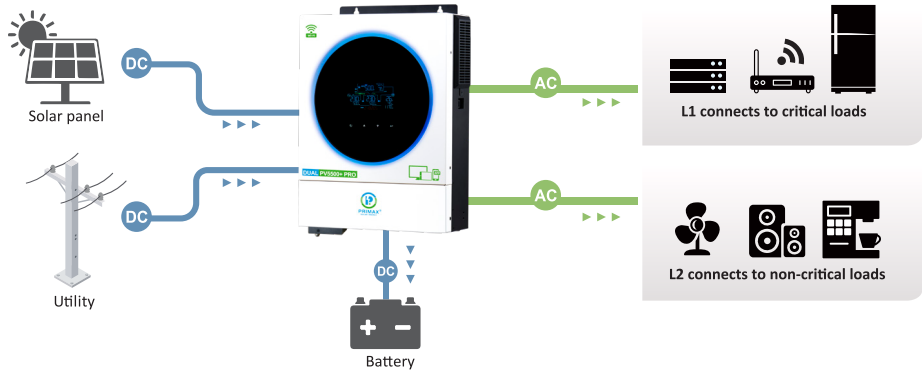

No PV energy is available.

2

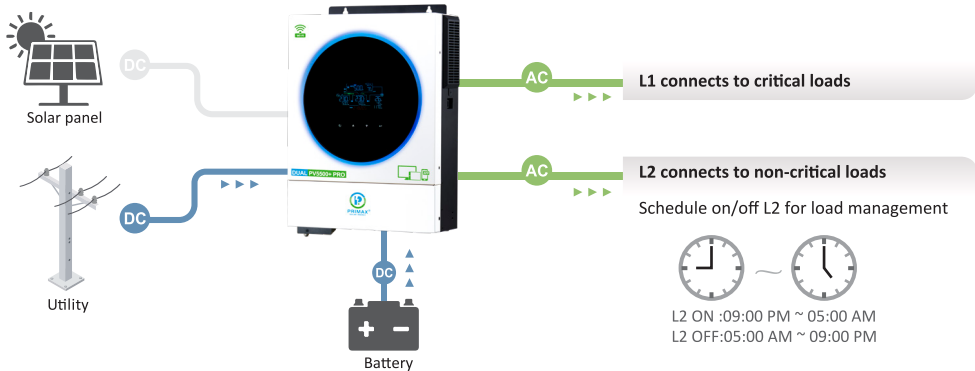

Only battery energy provides power to the loads.

3

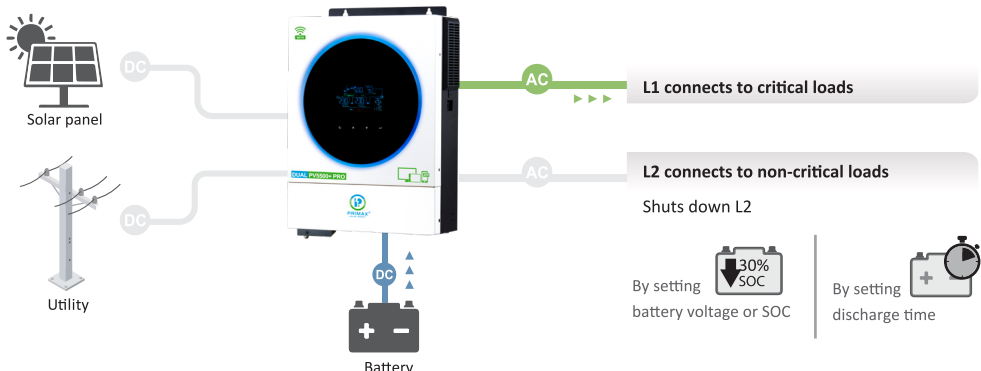

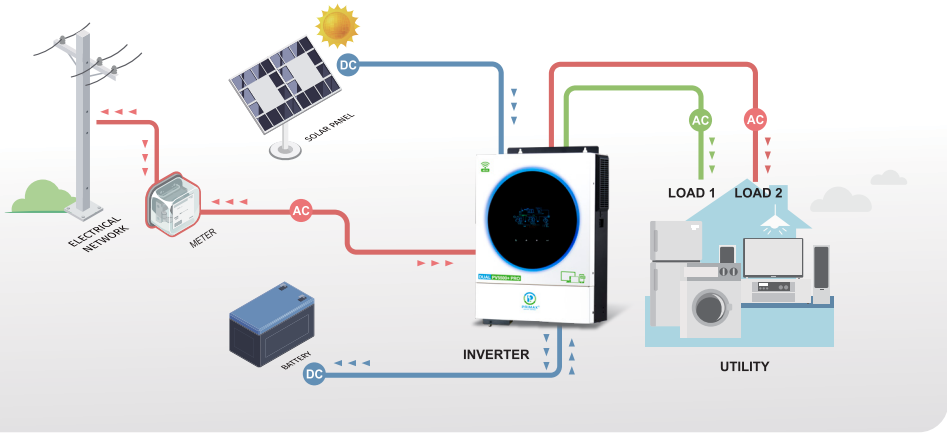

<b>MODEL</b>	<b>GALAXY DUAL PV5500+ PRO</b>
<b>RATED POWER</b>	4000VA/4000W
<b>INPUT</b>	
Voltage	230 VAC
Selectable Voltage Range	170-280 VAC (For Personal Computers) ; 90-280 VAC (For Home Appliances)
Frequency Range	50 Hz/60 Hz (Auto sensing)
<b>OUTPUT</b>	
AC Voltage Regulation (Batt. Mode)	230VAC ± 10%
Surge Power	8000VA
Efficiency (Peak)	90% ~ 93%
Transfer Time	10 ms (For Personal Computers) 20 ms (For Home Appliances)
Waveform	Pure sine wave
<b>BATTERY</b>	
Battery Voltage	24 VDC
Floating Charge Voltage	27 VDC
Overcharge Protection	33 VDC
<b>SOLAR CHARGER &amp; AC CHARGER</b>	
Solar Charger type	MPPT
Maximum PV Array Power	55000W
MPP Range @ Operating Voltage	60 ~ 450 VDC
Maximum PV Array Open Circuit Voltage	500 VDC
Maximum PV Input Current	27A
Maximum Solar Charge Current	120A
Maximum AC Charge Current	100A
Maximum Charge Current	120A
<b>PHYSICAL</b>	
Dimension, D x W x H (mm)	119 x 313.6 x 457.5
Net Weight (kgs)	10
Communication Interface	USB/RS232/RS485/WiFi/Dry-contact
<b>OPERATING ENVIRONMENT</b>	
Humidity	5% to 95% Relative Humidity (Non-condensing)
Operating Temperature	-10°C to 50°C
Storage Temperature	-15°C to 60°C

Product specifications are subject to change without further notice.

