

SOLAR CAPACITY **7000W**



PRIMAX[®]
SOLAR ENERGY



GALAXY DUAL PV7000+ PRO

MPPT Solar Inverter

FEATURES :

- Dual output for smart load management
- Maximum PV input current 27A
- Wide PV input voltage range 60VDC~450VDC
- Touchable button with large 4.3" colored LCD
- Customizable status LED ring with RGB lights
- Built-in Wifi for mobile monitoring (Android/iOS App available)
- Supports USB On-the-Go function
- Reserved communication port (RS485, CAN-BUS or RS232) for BMS
- Maximum charging current 120A
- Battery independent design
- Feed-in to the grid with storage backup
- Battery equalization extends lifecycle
- Built-in anti-dust kit
- Data log event stored in the inverter



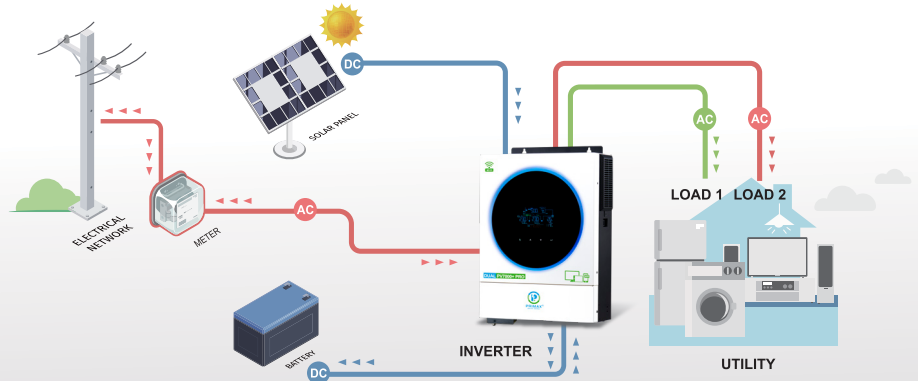

Dual Output Operation

When PV energy and Utility are available and sufficient

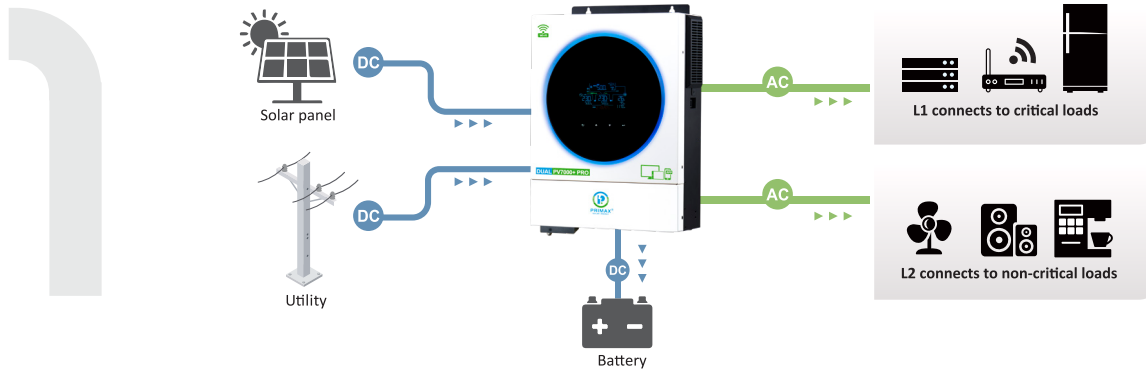

No PV energy is available.

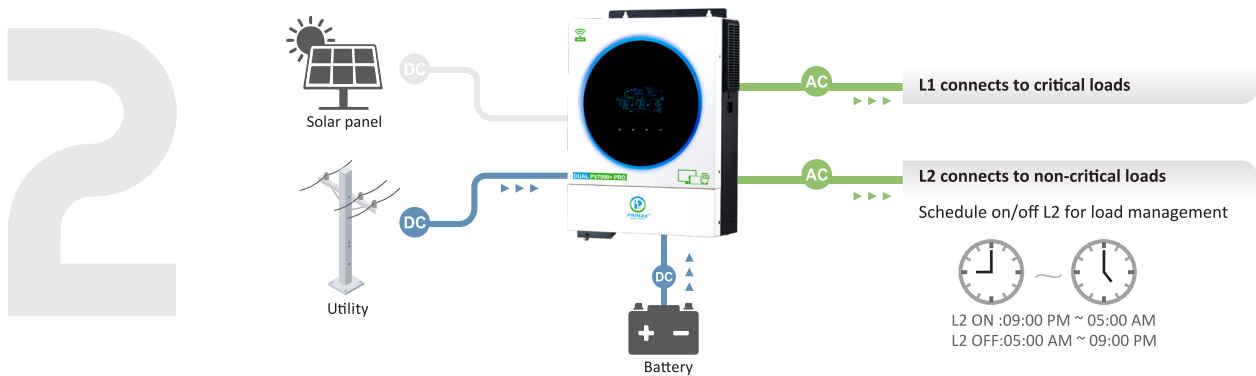

Only battery energy provides power to the loads.

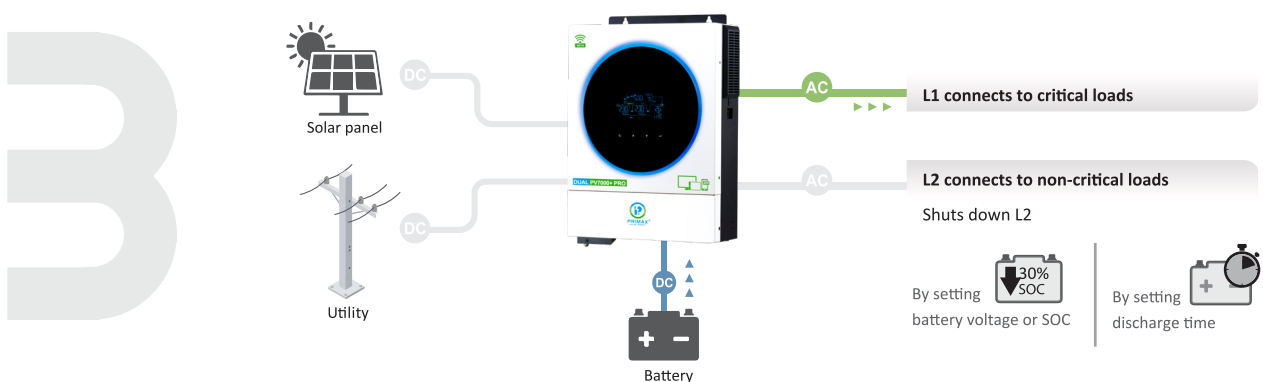

MPPT Solar Inverter | 6000 Watt

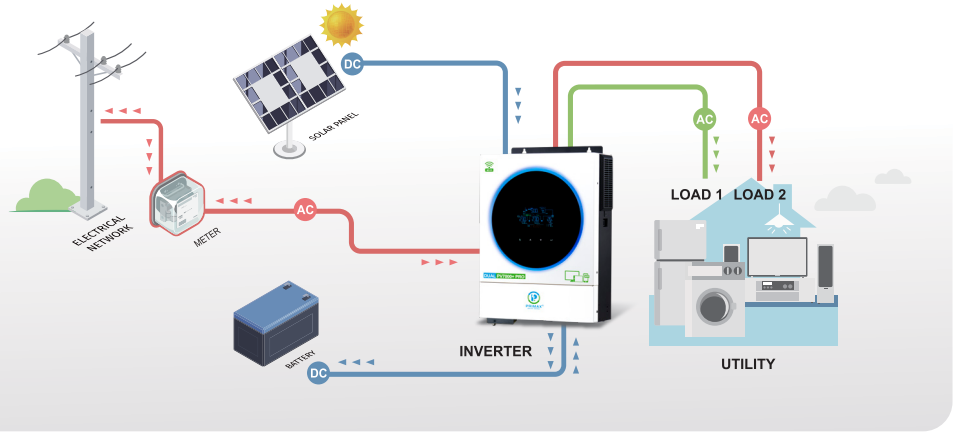

MODEL	GALAXY DUAL PV7000+PRO
RATED POWER	6000VA/6000W
INPUT	
Voltage	230 VAC
Selectable Voltage Range	170-280 VAC (For Personal Computers) ; 90-280 VAC (For Home Appliances)
Frequency Range	50 Hz/60 Hz (Auto sensing)
OUTPUT	
AC Voltage Regulation (Batt. Mode)	230VAC \pm 10%
Surge Power	12000VA
Efficiency (Peak)	90% ~ 93%
Transfer Time	15 ms (For Personal Computers) 20 ms (For Home Appliances)
Waveform	Pure sine wave
BATTERY	
Battery Voltage	48 VDC
Floating Charge Voltage	54 VDC
Overcharge Protection	63 VDC
SOLAR CHARGER & AC CHARGER	
Solar Charger type	MPPT
Maximum PV Array Power	7000W
MPP Range @ Operating Voltage	60 ~ 450 VDC
Maximum PV Array Open Circuit Voltage	500 VDC
Maximum PV Input Current	27A
Maximum Solar Charge Current	120A
Maximum AC Charge Current	100A
Maximum Charge Current	120A
PHYSICAL	
Dimension, D x W x H (mm)	119 x 313.6 x 457.5
Net Weight (kgs)	12
Communication Interface	USB/RS232/RS485/WiFi/Dry-contact
OPERATING ENVIRONMENT	
Humidity	5% to 95% Relative Humidity (Non-condensing)
Operating Temperature	-10°C to 50°C
Storage Temperature	-15°C to 60°C

Product specifications are subject to change without further notice.



info@primaxsolarenergy.com



www.primaxsolarenergy.com