

SOLAR CAPACITY **7500W**



PRIMAX[®]
SOLAR ENERGY



GALAXY DUAL PV7500+ MAX

MPPT Solar Inverter

FEATURES :

- Feed-in to the grid with storage backup
- Dual outputs for smart load management
- Maximum PV input current 27A
- Customizable status LED ring with RGB lights
- Touchable button with 4.3" colored LCD
- Built-in Wi-Fi for mobile monitoring (App is available)
- Supports USB On-the-Go function
- Reserved communication port for BMS
- Maximum charging current 120A
- Parallel operation up to 9 units
- Built-in anti-dust kit
- Maximum AC output 6000W



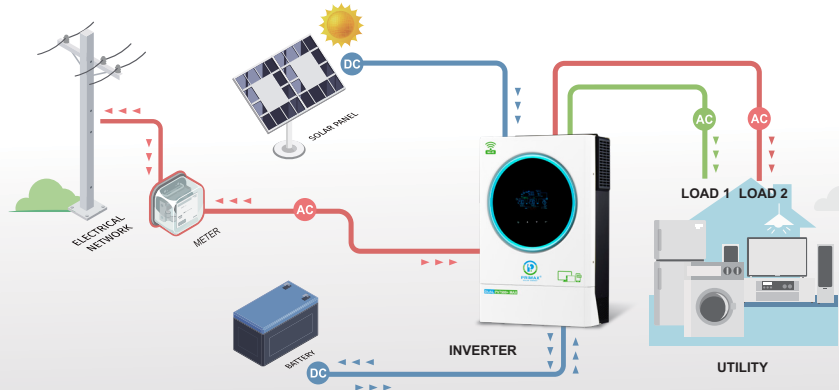

Dual Output Operation

When PV energy and Utility are available and sufficient

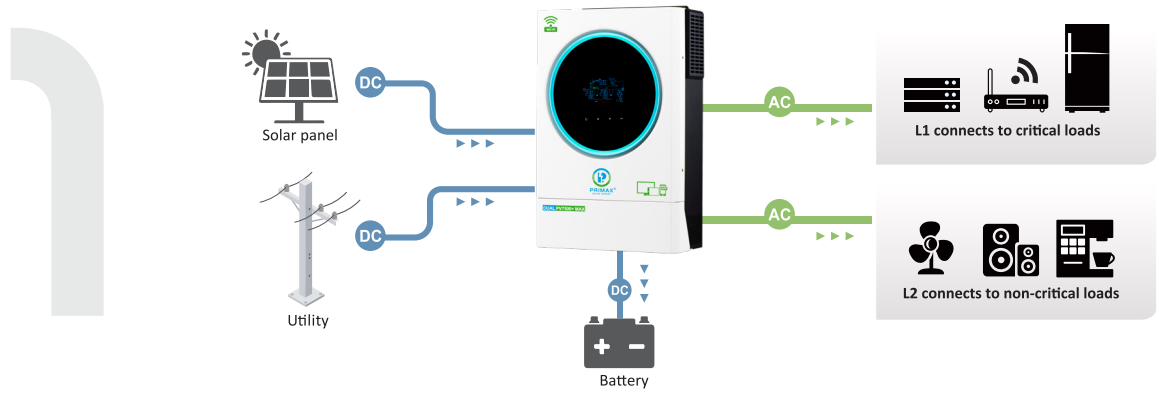

No PV energy is available.

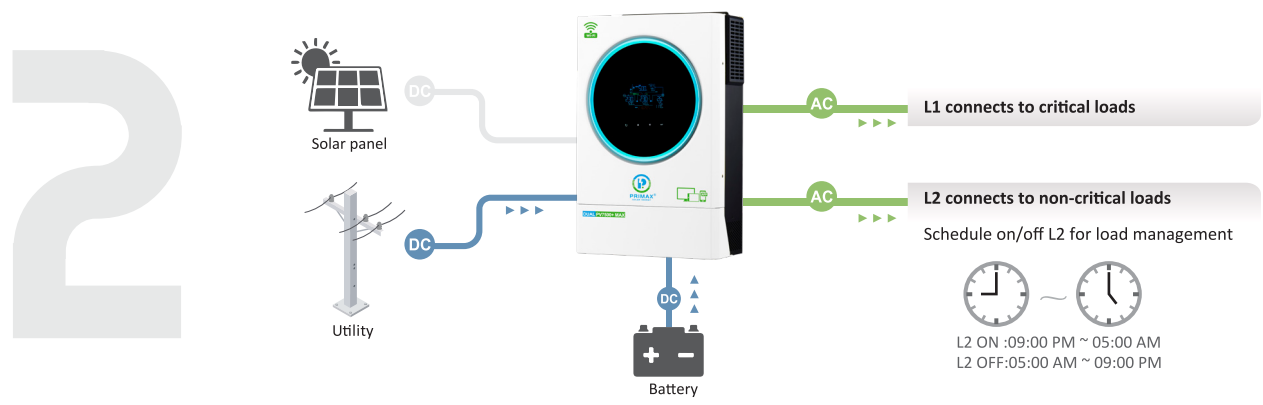

Only battery energy provides power to the loads.

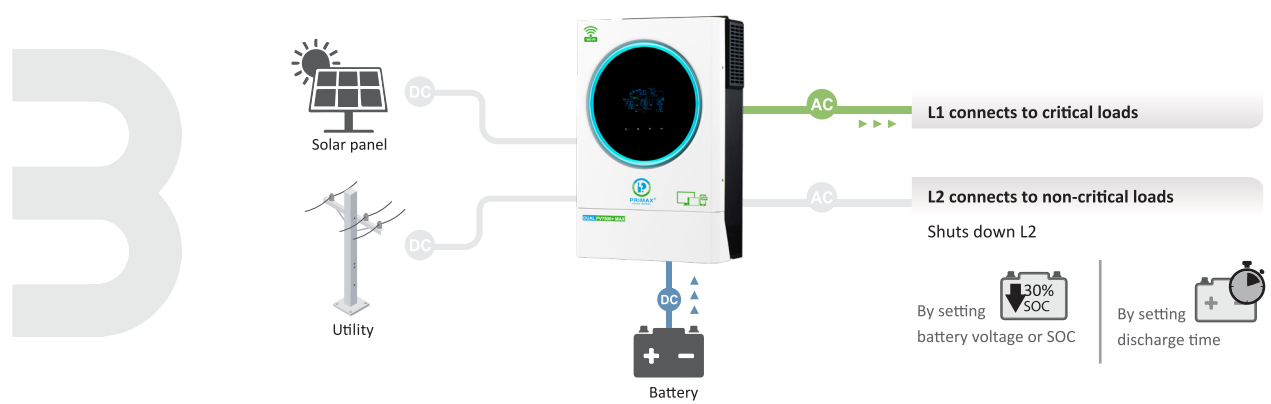

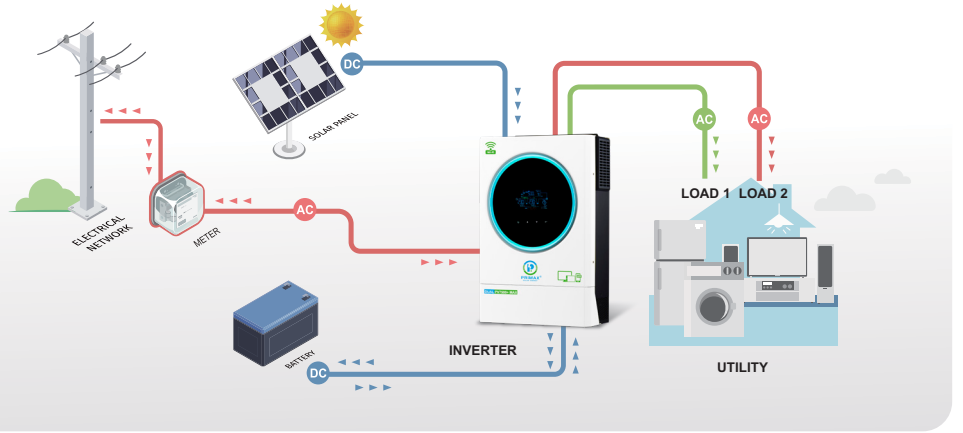

MODEL	GALAXY DUAL PV7500+ MAX
PHASE	1-phase in / 1-phase out
MAXIMUM PV INPUT POWER	7000W
RATED OUTPUT POWER	6000W
MAXIMUM CHARGING POWER	6000W
GRID OPERATIONS	
PV INPUT (DC)	
Nominal DC Voltage / Maximum DC Voltage	360 VDC / 500 VDC
Start-up Voltage / Initial Feeding Voltage	120VDC / 150 VDC
MPP Voltage Range	120 VDC ~ 430 VDC
Number of MPP Trackers / Maximum Input Current	1 / 27A
GRID OUTPUT (AC)	
Nominal Output Voltage	220/230/240 VAC
Output Voltage Range	184 - 264.5 VAC or 195.5 - 253 VAC (Selectable)
Nominal Output Current	26A
Power Factor	> 0.99
EFFICIENCY	
Maximum Conversion Efficiency (DC/AC)	96%
OFF-GRID OPERATION	
AC INPUT	
AC Start-up Voltage / Auto Restart Voltage	120 - 140 VAC / 180 VAC
Acceptable Input Voltage Range	90 - 280 VAC or 170 - 280 VAC
Maximum AC Input Current	40 A
PV INPUT (DC)	
Maximum DC Voltage	500 VDC
MPP Voltage Range	120 VDC ~ 430 VDC
Number of MPP Trackers / Maximum Input Current	1 / 27 A
BATTERY MODE OUTPUT (AC)	
Nominal Output Voltage	220/230/240 VAC
Output Waveform	Pure sinewave
Efficiency (DC to AC)	93%
COMBINED OPERATIONS	
PV INPUT (DC)	
Nominal DC Voltage / Maximum DC Voltage	360 VDC / 500 VDC
Start-up Voltage / Initial Feeding Voltage	120VDC / 150 VDC
MPP Voltage Range	120 VDC ~ 430 VDC
Number of MPP Trackers / Maximum Input Current	1 / 27A
GRID OUTPUT (AC)	
Nominal Output Voltage	220/230/240 VAC
Output Voltage Range	184 - 264.5 VAC or 195.5 - 253 VAC (Selectable)
Nominal Output Current	26A
AC INPUT	
AC Start-up Voltage / Auto Restart Voltage	120 - 140 VAC / 180 VAC
Acceptable Input Voltage Range	90 - 280 VAC or 170 - 280 VAC
Maximum AC Input Current	40A
BATTERY MODE OUTPUT (AC)	
Nominal Output Voltage	220/230/240 VAC
Efficiency (DC to AC)	93%
BATTERY & CHARGER	
Nominal DC Voltage	48 VDC
Maximum Solar Charging Current	120A
Maximum AC Charging Current	120A
Maximum Charging Current	120A
GENERAL	
PHYSICAL	
Dimension, D x W x H (mm)	140 x 295 x 468
Net Weight (kgs)	12
INTERFACE	
Parallel Function	Yes, 9 units
Communication Port	USB/RS232/RS485/Wifi/Dry-contact
ENVIRONMENT	
Humidity	0 ~ 90% RH (Non-condensing)
Operating Temperature	-10 to 50°C

Product specifications are subject to change without further not