

120A
MAX PV
CHARGING

PURE
SINE WAVE

WORKS
WITH AND WITHOUT
BATTERY

APP

WIFI&GPRS

LI-ION

UPGRADED
MPPT

BUILT IN
ANTI DUST
KIT

RGB
LIGHTS

LCD Display

Features

- Pure sine wave solar inverter(on/off Grid)
- Output power factor 1.0
- WIFI&GPRS available for IOS and Android(Optional)
- Inverter can run without battery
- One-key restoration to factory Settings
- Built-in Lithium battery automatic activation
- Built-in 120A MPPT Solar charge:max 6200W(for 3.6KW/4.2KW), max 7200W (for 6.2KW)
- High PV input voltage range(60~450VDC)
- Built-in anti-dust kit for harsh environment
- Smart battery charge design to optimize battery life
- Dual output

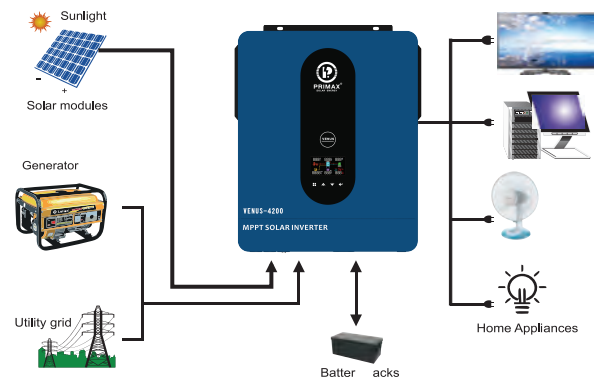

MODEL	VENUS-4200
Phase	1-phase
Maximum PV Input Power	6200W
Rated Output Power	4200W
Maximum Solar Charging Current	120A
GRID- OPERATION	
PV INPUT (DC)	
Nominal DC Voltage/Maximum DC Voltage	360/500VDC
Start-up Voltage / Initial Feeding Voltage	60VDC/90VDC
MPPT Voltage Range	60~450VDC
Maximum Input Current	1/18A

GRID OUTPUT (AC)	
Nominal Output Voltage	220/230/240VAC
Output Voltage Range	195.5~253VAC
Nominal Output Current	18.2A
Power Factor	>0.99
EFFICIENCY	
Maximum Conversion Efficiency (DC/AC)	98%
TWO LOAD OUTPUT POWER	
Full Load	4200W
Maxium Main Load	4200W
Maxium Second Load(battery mode)	1400W
Maxium Load Cut Off Voltage	26VDC
Maxium Load Return Voltage	27VDC
OFF-GRID OPERATION	
AC INPUT	
AC Start-up Voltage / Auto Restart Voltage	120-140VAC/180VAC
Acceptable Input Voltage Range	90-280VAC or 170-280VAC
Frequency Range	49~51±1HZ
Maximum AC Input Current	30A
PV INPUT (DC)	
Nominal DC Voltage/Maximum DC Voltage	360/500VDC
MPPT Voltage Range	60~450VDC
Maximum Input Current	1/18A
BATTERY MODE OUTPUT (AC)	
Nominal Output Voltage	220/230/240VAC
Output Waveform	Pure sine wave
Efficiency (DC to AC)	94%
BATTERY & CHARGER	
Nominal DC Voltage	24VDC
Maximum Solar Charging Current	140A
Maximum AC Charging Current	100A
Maximum Charging Current	140A
COMBINED OPERATION	
PV INPUT (DC)	
Nominal DC Voltage/Maximum DC Voltage	360/500VDC
Start-up Voltage / Initial Feeding Voltage	90VDC/120VDC
MPPT Voltage Range	60~450VDC
Maximum Input Current	1/18A
GRID OUTPUT (AC)	
Nominal Output Voltage	220/230/240VAC
Output Voltage Range	195.5~253VAC
Nominal Output Current	18.2A
AC INPUT	
AC Start-up Voltage / Auto Restart Voltage	120-140VAC/180VAC
Acceptable Input Voltage Range	90-280VAC or 170-280VAC
Maximum AC Input Current	30A
Maximum AC Charging Current	100A
GENERAL	
PHYSICAL	
Dimension, D x W x H (mm)	420*350*110
Carton Dimension,D X W XH(mm)	500*415*180
Net Weight (kgs)	8.5
Gross Weight(kgs)	9.5
INTERACE	
Communication Port	RS232/RS485/WIFI/GPRS/LITHIUM BATTERY
ENVIRONMENT	
Humidity	5% to 95% Relative Humidity(Non - condensing)
Operating Temperature	-10°C ~ 50°C
STANDARD	
Compliance Safety	CE