



**160A**  
MAX PV  
CHARGING

DUAL  
SMART & MAIN LOAD

Touch Control

APP

WIFI&GPRS

Dual PV

UPGRADED  
MPPT

WORKS WITH  
AND WITHOUT  
BATTERY

**RGB**  
LIGHTS

## Features

- Pure sine wave solar inverter(on/off Grid)
- Output power factor 1.0
- WIFI&GPRS available for IOS and Android (Optional)
- Inverter can run without battery
- One-key restoration to factory Settings
- Built-in Lithium battery automatic activation
- Built-in 160A MPPT solar charger (for 8.2kw, 10.2kw), 140A(for 7.2kw)
- High PV input voltage range(90~ 450VDC)
- Built-in anti-dust kit for harsh environment
- Smart battery charge design to optimize battery life
- Dual output
- Dual PV input
- Touch button

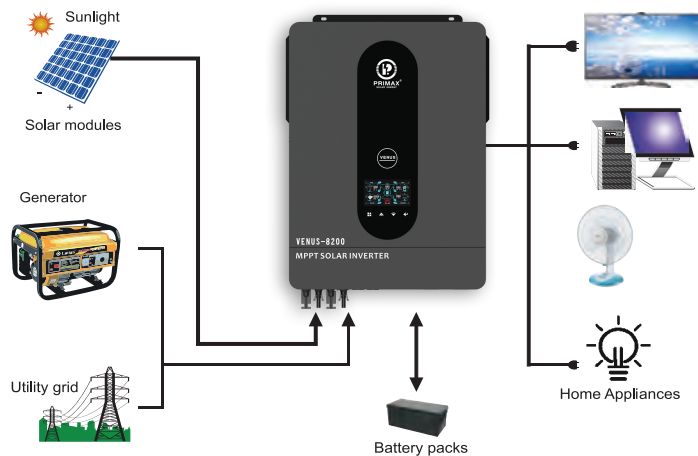

MODEL	VENUS-8200
Phase	1-phase
Maximum PV Input Power	5600W+5600W
Rated Output Power	8200W/8200VA
Maximum Solar Charging Current	160A
<b>GRID-OPERATION</b>	
<b>PV INPUT (DC)</b>	
Nominal DC Voltage/Maximum DC Voltage	360/500VDC
Start-up Voltage / Initial Feeding Voltage	90VDC/120VDC
MPPT Voltage Range	90~450VDC
Maximum Input Current	2/18A

GRID OUTPUT (AC)	
Nominal Output Voltage	220/230/240VAC
Output Voltage Range	190~253VDC
Nominal Output Current	35.6A
Power Factor	>0.99
<b>EFFICIENCY</b>	
Maximum Conversion Efficiency (DC/AC)	98%
<b>TWO LOAD OUTPUT POWER</b>	
Full Load	8200W
Maxium Main Load	8200W
Maxium Second Load(battery mode)	2733W
Maxium Load Cut Off Voltage	52VDC
Maxium Load Return Voltage	54VDC
<b>OFF-GRID OPERATION</b>	
<b>AC INPUT</b>	
AC Start-up Voltage / Auto Restart Voltage	120-140VAC/180VAC
Acceptable Input Voltage Range	90-280VACor170-280VAC
Frequency Range	49~51±1HZ
Maximum AC Input Current	40A
<b>PV INPUT (DC)</b>	
Nominal DC Voltage/Maximum DC Voltage	360/500VDC
MPPT Voltage Range	90~450VDC
Maximum Input Current	2/18A
<b>BATTERY MODE OUTPUT (AC)</b>	
Nominal Output Voltage	220/230/240VAC
Output Waveform	Pure sine wave
Efficiency (DC to AC)	94%
<b>BATTERY &amp; CHARGER</b>	
Nominal DC Voltage	48VDC
Maximum Solar Charging Current	160A
Maximum AC Charging Current	140A
Maximum Charging Current	160A
<b>COMBINED OPERATION</b>	
<b>PV INPUT (DC)</b>	
Nominal DC Voltage/Maximum DC Voltage	360/500VDC
Start-up Voltage / Initial Feeding Voltage	90VDC/120VDC
MPPT Voltage Range	90~450VDC
Maximum Input Current	2/18A
<b>GRID OUTPUT (AC)</b>	
Nominal Output Voltage	220/230/240VAC
Output Voltage Range	190~253VDC
Nominal Output Current	35.6A
<b>AC INPUT</b>	
AC Start-up Voltage / Auto Restart Voltage	120-140VAC/180VAC
Acceptable Input Voltage Range	90-280VACor170-180VAC
Maximum AC Input Current	40A
Maximum AC Charging Current	140A
<b>GENERAL</b>	
<b>PHYSICAL</b>	
Dimension, D x W x H (mm)	530*420*160
Carton Dimension,D X W XH(mm)	618*463*205
Net Weight (kgs)	14.6
Gross Weight(kgs)	16.1
<b>INTERACE</b>	
Communication Port	RS232/RS485/WIFI/GPRS/LITHIUM BATTERY
<b>ENVIRONMENT</b>	
Humidity	5% to 95% Relative Humidity(Non - condensing)
Operating Temperature	-10°C ~ 50°C
<b>STANDARD</b>	
Compliance Safety	CE